

Exterior Doors

- ✓ **Insulation Value (U-Factor):** Does it meet strict energy codes and support interior climate goals?
- ✓ **Air Leakage:** Does it have a certified rating and robust perimeter sealing to prevent the infiltration of unconditioned air and contaminants?
- ✓ **Wind & Weather Resistance:** Is it engineered to handle local environmental conditions and heavy-duty, high-cycle use?
- ✓ **Durability & Cycle Life:** Is the door heavy-duty, and can it handle high-cycle usage common at loading docks?

Interior Fire & Smoke Doors

- ✓ **Fire Rating:** Does the door's hour rating perfectly match the compartmentalization requirements of the surrounding wall?
- ✓ **Smoke Control:** Is it explicitly rated (e.g., UL 1784) to block smoke and draft migration?
- ✓ **Automation & Integration:** Does the operator seamlessly tie into building fire alarms and feature a reliable battery backup for fail-safe operation during an outage?

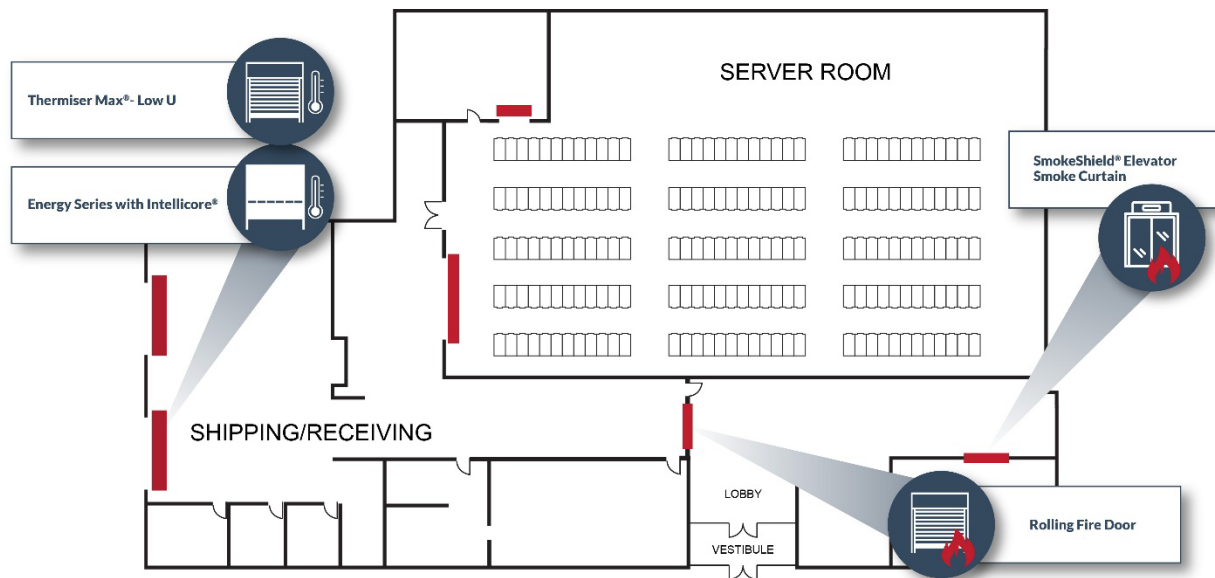

From initial concept to final specification, our ADS Team is here for you.

(855) 948-3414 | [Find An Expert](#)