

EVERGARD™ TUBE MOTOR OPERATOR

Battery Backup (BBU) Tube Motor

The EverGard Tube Motor operator is ideal for openings with tight clearances around the coil area, when you need to neatly conceal the drive components without adding a bulky motor cover and for door control during a loss of power. EverGard Tube Motor is available on counter doors, grilles and light gauge service doors (22 & 24 gauge).

STANDARD FEATURES AND BENEFITS

- ▶ Totally Enclosed Non-Ventilated (TENV) motor
- ▶ AC/DC input powers auto switching
- ▶ Auto-Recharge Battery
- ▶ Integrated battery backup allows for operation for up to 10 cycles in a 48-hour time period in the event of a power outage
- ▶ UL 325 listed
- ▶ Non-resettable cycle counter
- ▶ Programmable battery self-testing
- ▶ Remote programmable control box comes standard with 12' of cable*
- ▶ Speed governor to prevent free fall
- ▶ Programmable CONSTANT or MOMENTARY contact open and close
- ▶ Continuous monitoring sensing edge device ELR/IR connecting points
- ▶ Selectable “Auto-Open” or “Stay in Position” function if BBU reaches critically low voltage
- ▶ Selectable “Auto-Open” or “Stay in Position” function at AC power loss
- ▶ Abnormal power warning LED with selectable audible alert

STANDARD COMPONENTS

BRAKE - Maintenance-free, solenoid-actuated brake that is speed governed to prevent free fall

EXTERNAL BATTERY INDICATOR - Backlight flashes when power is abnormal

OPTIONAL COMPONENT

GUIDE-MOUNTED INTERLOCK - Prevents damage to the door and operator when the door is locked



TECHNICAL SPECIFICATIONS

Input Voltage.....120 VAC
Activation Input.....24 VDC
Phase.....1
Duty.....10 cycles / day

*The control panel can be installed up to 100' away from the operator as an option, but it may require factory installation

TUBE MOTOR FRONT

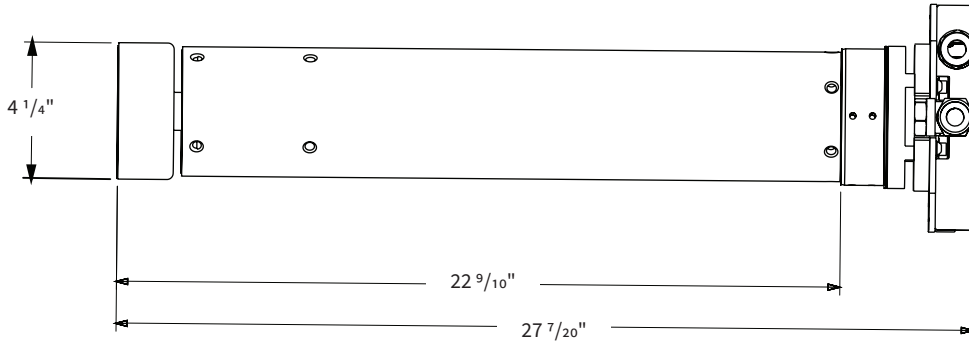

MOTOR CONTROL PANEL

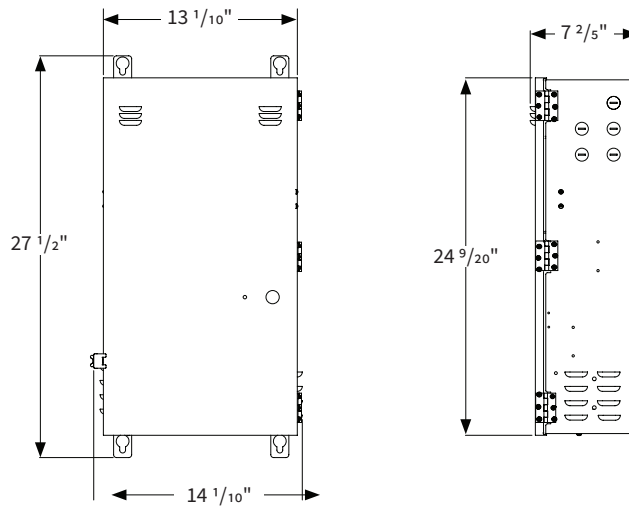

BATTERY INDICATOR

